

# WGB014 Gear Box

## Assembly suggestions

For 2mm axles

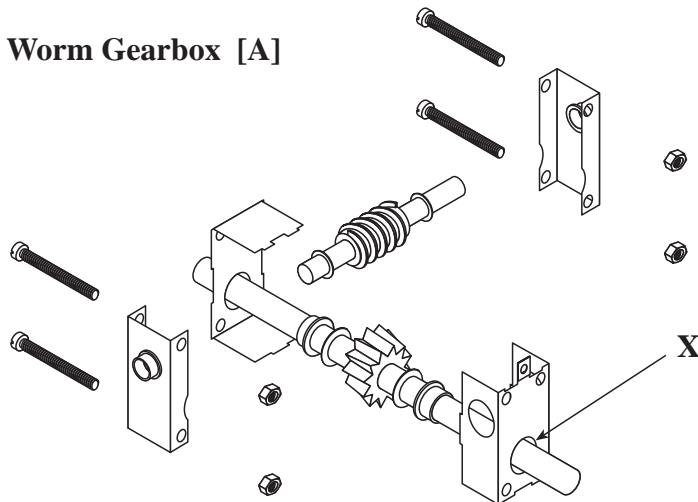

More information and photos can be on the CLAG website  
<http://www.users.globalnet.co.uk/~phold/clag/bb14.html>

### Errata

The axle bearings have been change to shorter one more appropriate to a gearbox, however they have a larger outside diameter. To get these new bearings to fit the hole in the sideplates marked 'X' will have to be eased with a broach.

---

**Bill Bedford Models**

**4 Belgrave Rd George St, Pontypool, NP4 8NP**